

INSTRUCTIONS MANUAL

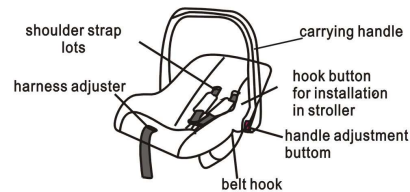

Keep this manual in a safe place future reference.

No child restraint can guarantee absolute protection from injury in every crash. However to ensure that your child gets all the protection designed into the restraint, please read and follow this instructions exactly.

Warning!---Extreme Danger

Do not use a rear-facing car seat on front passenger seat where a passenger side airbag is fitted. Airbag inflates rapidly and can throw a rear-facing child restraint into seat back with a great force, which can injure child.

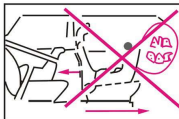

A.WARNINGS

Warning!: Failure to follow each of the following instructions can result in your child striking the vehicle's interior during a sudden stop or crash.

1. Only suitable if the approved vehicles are fitted a 3-point safety belts with retractor approved to UN/ECE Regulation No.16 or other equivalent standards.
2. Rigid items and plastic parts of a child restraint system must be so located and installed that they are not liable, during everyday use of the vehicle, to become trapped by a moveable seat or in a door of the vehicle.
3. This rear-facing child restraint system can not be used in seating positions where there is an airbag installed.
4. Take care that the straps, holding the restraint to the vehicle, shall be as tight as possible. Make sure that the straps, restraining the child should be adjusted to the child's body and the straps should not be twisted.
5. It is important that the lap part of the harness belt system is worn low down, so that the pelvis is firmly engaged.
6. The child restraint system **MUST BE CHANGED** after it has been suffered from a violent impact in an accident.

B. INSTRUCTIONS FOR USE

1. This child restraint is designed for use by children whose weight 13kg or less and whose heights are 26 inches (66cm) or less.
2. This child restraint is only used rear-facing

position, and can not be used forward-facing position

For maximum protection, the center rear seat position is recommended for installing a child restraint. Only when the seat is provided with a 3-point adult belt

All seat cover on the restraint are removable for cleaning. And you can simply blot the desired area with a damp sponge and cool water.

Your child restraint should not be purchased or sold as a second hand item. It is recommended not to use child restraint older than 6 years as the protection in an accident may be reduced.

C.ADJUSTMENTS

1.Handle adjustments

Face the restraint: push the red button on each side of handle, rotate and release red button to desired position until hearing a "click". There are three positions available. See the picture.

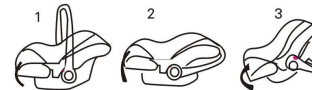

IMPORTANT: Before lifting car seat, place handle in "locked" upright carrying position.

2.Harness adjustment

This car seat has 2 sets of slots. Select the

suitable slots according to child's physique.

To change the harness strap position, undo the harness strap from the seat buckle,

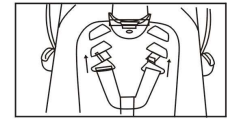

come out from belt slots on the back of car seat and re-thread them through the desired slots. Reconnect the straps to seat buckle.

D.INSTALLATION

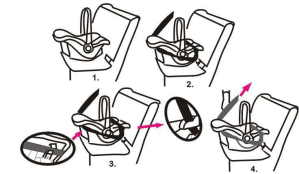

Please refer to graphic above for installation.

1. Place car seat REAR-FACING on vehicle seat.
2. Thread vehicle lap belt through car seat SLOTS and buckle belt.

NOTE: Vehicle shoulder belt must not be placed through car seat's slots.

3. Pull front to back and left to right to check for secure installation.

NOTE: Vehicle **MUST** be on level ground and child in car seat when leveling.

E.PLACE YOUR CHILD IN THE RESTRAINT

1. See the graphic in D from step 1-step 5. for

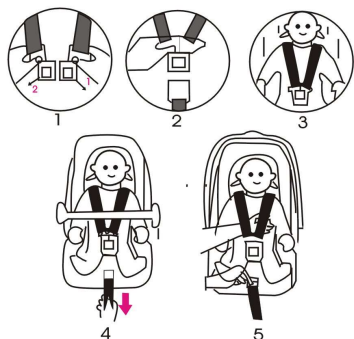

installing your child restraint on car seat.

2. Press the release button on buckle, unfasten the buckle connector 1 & 2.
3. Lift up the harness straps and lay them flat on the back of restraint.
4. Place your child in restraint.

Note: Do not place your child in a sleeping bag, blanket or other bulky wrapping before putting child in the restraint. The shoulder straps will not fit snugly and the child won't be safe.

5. Put the harness straps on each side of child's shoulder.

Remark: A newborn baby will need extra support around the head and body. Please don't remove the cushion if you are going to use it of your newborn baby or baby less than 7 months.

PS: the cushion is alternative item, please asking sell agent regarding to this extra selection.

6. Join the two buckle connectors, passing the left "1" under the right "2", and inserting them both into the buckle until you hear a "click" signifying the buckle is locked.

7. Pull the harness adjuster lock to the position you desired.

8. Check that harness straps are snug with just enough room to insert one finger between child's Chest and harness straps.

Note: check that the buckle is secured by attempting to pull the above and below part to remove the connectors.

F. TAKE YOUR CHILD OUT OF RESTRAINT THEN REMOVE THE RESTRAINT OUT OF VEHICLE

1. Press the release button on buckle, unfasten the buckle connector 1 & 2.
2. Lift up the harness straps and lay them flat on the back of restraint.
3. Take your child out of restraint.
4. Unbuckle the vehicle seat belt.
5. Pull out the vehicle seat belt through the seat belt hooks in the restraint.
6. Remove the restraint out of vehicle.

G. THE TRAVELING NOTE

- Please take care that the child restraint system should be kept away from the sunlight. Some parts of the child restraint system may become too hot for child's skin.

- Do not leave the child unattended in child restraint system and in the car.
- While travelling it is recommended that any luggage or other objects liable to cause injuries in the event of a collision shall be properly secured.
- Please note that the Child restraint system never should be used without cover
- The seat cover should never be replaced with any other cover than the one recommended by the manufacturer. The cover constitutes an integral part of the restraint performance.
- Do not use your child restraint in vehicle seats with lap belts only.
- Your child restraint should be securely belted to the vehicle, even when unoccupied. Because in a crash an unsecured restraint may injure other occupants.
- Please take a rest in each two hours if you are traveling with baby in vehicles with car seat
- Please check the car seat condition if you are going to long traveling with child
- Please put all the edge stuff into trunk if you are going to travel with baby, because those items might hurt baby during unstable road travel conditions.
- Please always check the car seat before you placing baby into it.
- Please contact with sold agent if anything break. DON'T TRY TO FIX UP CAR SEAT BY YOURSELF. IT MIGHT BE DAMAGE FOR LATER

USED WITHOUT CERTAIN FIS KNOWLEDGE

H. NOTE FOR USER:

- Please remove child out of car as first priority when accident happens.
- Don't look after child when they were crying during the driving.
- Please always check buckle hole before buckle up.
- Please keep car seat out reach of child when it is not used.
- Please keep out reach of PE bag from child after unpack of car seat.
- Don't placing car seat on any seat content AIRBAG.
- Do not after or modify your restraint. Only the manufacturer or agent must do repairs.

1. CLEANING&WASHING NOTE

- For quickly clearing, simply blot the desired area with a mild soap solution using a damp sponge and cool water, if necessary can be hand wash.
- Clean up your car seat shell with mild solution soap and cool water. Never use "household detergents": they can weaken plastic.
- Harness straps are only surface washable with mild soap and damp cloth.
- Don't use wash machine to wash.
- Don't use hot water to wash.