

1.Unlocked the holding hook.Lift the handle up till the stroller expands as shown in the figure.

WARNING: Please confirm the stroller is locked before use.

2.Follow the drawing to assemble the rear wheel.

3.Insert rear wheels into rear tube,until make spring extrude from small hole.

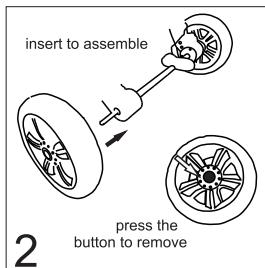

press the button to remove

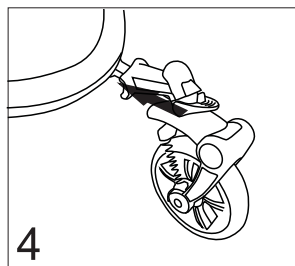
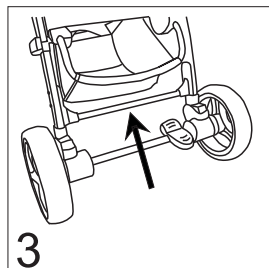

4. Insert front axle to hole of the front wheel, until it be locked.

5.Rotate the plastic part and fix it. And then hang on the basket hooks.

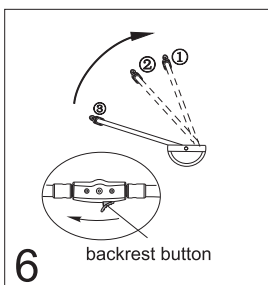
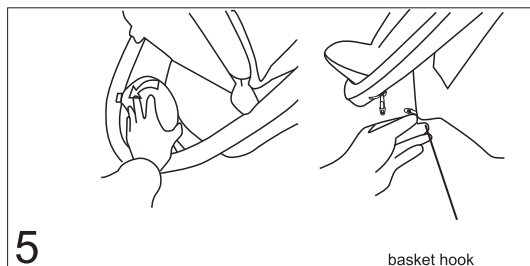

6.There are 3 positions for adjusting.To lower the backrest,push the backrest button located at the top of the seat and set the backrest to the desired backrest position.

Push the backrest forward get a more upright position.

7.The height of footrest could adjustable by two sides of button.

8.Put the canopy to adjust.

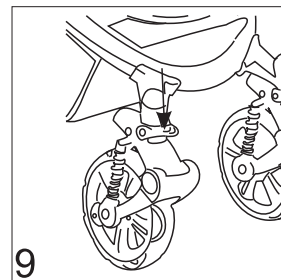
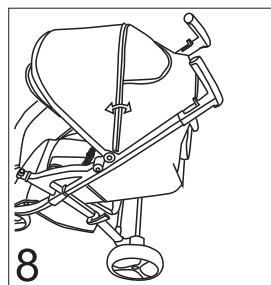
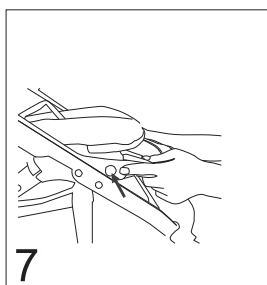

9.Pull up the orientation parts of front wheels, could fix the direction of stroller. Press down the orientation parts, the front wheels could be swivel.

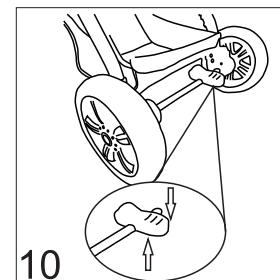

10.Insert the holes of rear axle inside of rear tube.(The brake levers must be facing out).Press the removing button could remove the rear axle. The parking device shall engaged when placing and removing the children.

11.THE ADJUSTMENT OF SAFETY BELT:The press button buckle can ensure the safety of your baby.Please fasten all buckles when you assembling it and using it.

WARNING: Use the saftey belt always! Do not use it when the belt easy broken.

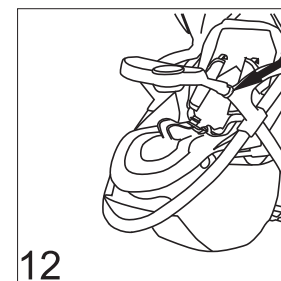
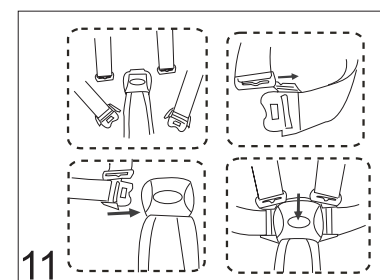

12.Downward the spring piece of tray, to insert the hole of tray's plug. Press the button then you could pull out the tray.

Warning: Make sure the tray was in right place before use.

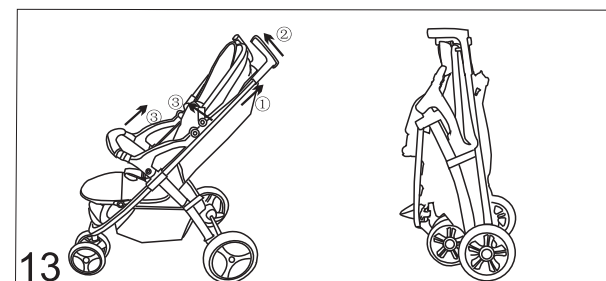

13.Folding A.close canopy and backrest firstly,as picture B.Hold 2 sides pushing handle by hands,pull folding hooks up by fingers (steps①),meantime,lift up pushing handle(steps②),finally,fold stroller frame(steps③),the folding hook can been lock automatically. self standing after folding.

WARNING

- Please be sure to strictly observe the following points, to avoid the accident happens.
- Avoid serious injury from falling or sliding out, always use safety harness provided.
- Never leave your child unattended.
- When children sit in stroller never carry it up.
- Never let stroller be used in steep slope, stairs, escalators, sand beach, uneven roads and mud.
- Don't let children stand in the stroller.
- Never allow more than one child at a time in the stroller. And be sure the children sit in the cart seat.
- Maximum load weight is 15KGS.
- Never hang anything of canopy or handle (inclusive bag). This may cause the stroller to become unstable.
- Do not overload the basket. Maximum load weight is below 3KGS. Excessive weight may cause a hazardous unstable condition to exist.
- Ensure all locking device are in a locked state before use stroller.
- To fix the brakes when the stroller stop, to prevent the stroller moving.
- In order to avoid baby getting injured, when the handle reversible, don't let the child's arm to put within the scope of handle's activities. Check carefully the handle has been fixed after it changed forward.
- Please throw away the bag immediately, if your children wear it, it would be the danger of suffocation.
- Regularly check all screws, bolts and nuts.
- Do not let your stroller near by fire.
- This stroller is designed for a child 6 to 36 months.
- Executive Standard: EN1888-2003(E).

Maintenances

- Clean canopy/safety belts/ fixed base and basket, scrub and wipe, then dry. For especially dirty parts, first diluted detergent, then wash it, after that wipe it dry.
- Wipe off the marl, and then use a damp cloth to clean the stroller frame, finally wipe the stroller with a dry cloth. If not dry, the stroller body will be aging black.
- Do not use bleacher, put the cushion in the dark place to dry in the shade. Do not use dryer to dry it.
- Do not let your stroller in direct sunlight, Otherwise, the plastic and fabric parts will fade. .
- Due to the continuous improvement of products, design and specifications are subject to change without notice.
- The pictures in instructions just for reference, but could not represent the actual product.

The multifunctional baby stroller instruction

To make sure how to use the stroller, please read the instruction carefully, keep it safe for future reference. If you do not follow instructions to use the stroller, may affect children's safety. If you assign the stroller, please assign this instruction together.

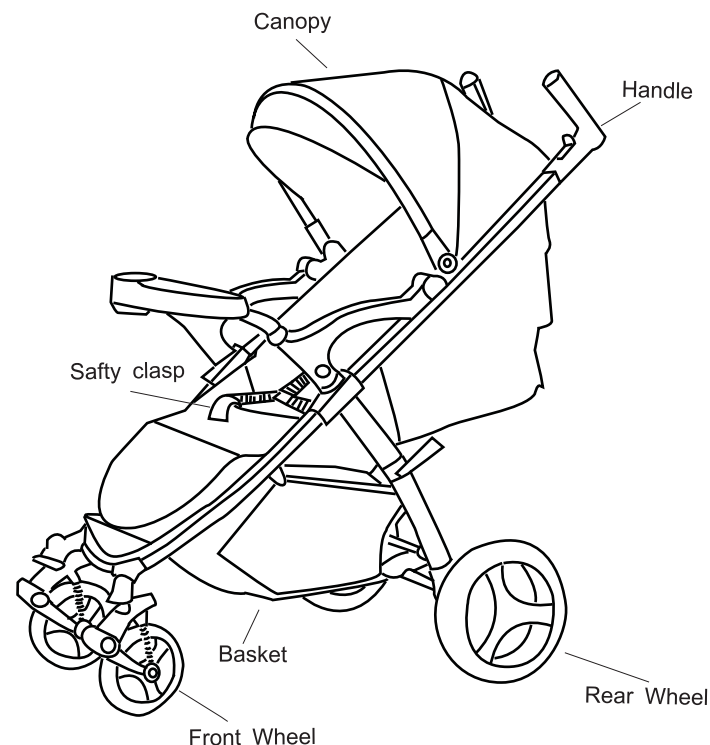

- ✦ Big basket.
- ✦ Adjustable footrest.
- ✦ 3 position of backrest could seat and sleeping.
- ✦ The front wheels could fix or swivel.
- ✦ Operate unit-brake for rear wheels .